

# REMINGTON LAND NOTES



## 202<sup>nd</sup> Entrance

RHOA owns most of the land the 3-rail fence is on, as displayed in yellow at left. All portions of the fence on lot 26 are on the homeowner's property, and most of the fence on lot 10 is on the homeowner's property.



## 207<sup>th</sup> Entrance

RHOA owns all the land the 3-rail fence is on.

## Back Entrance

RHOA does not appear to own any of the land the 3-rail fence is on. No map is included.

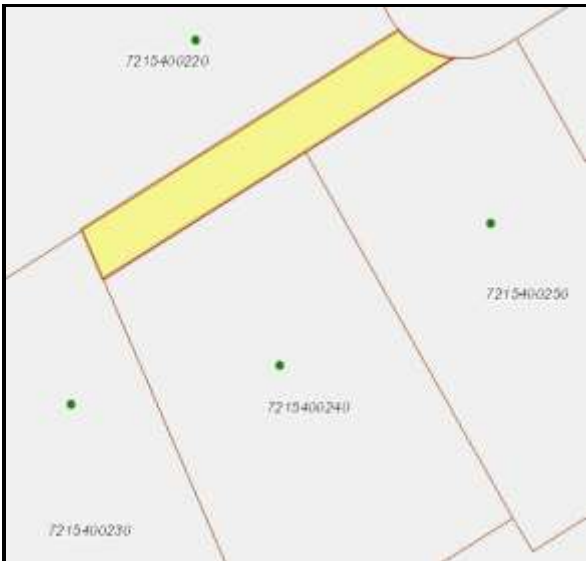

## SE 296<sup>th</sup> St. – west end

This Easement, shown in yellow, is known as Tract B.

“Lots 23 and 24 [Div. 1] shall have undivided ownership of this tract and will be responsible for its maintenance.”

As noted on page 144/44 of Remington Div 1 plat maps, marked “Sheet 1 of 7 Sheets”, “226-56”. See page 144/48, marked “Sheet 5 of 7” “226-56D” for larger, more detailed map.